

3/8-1/2" X 8 PLCS EQUAL SPACED (45°) ON TOP. **A**

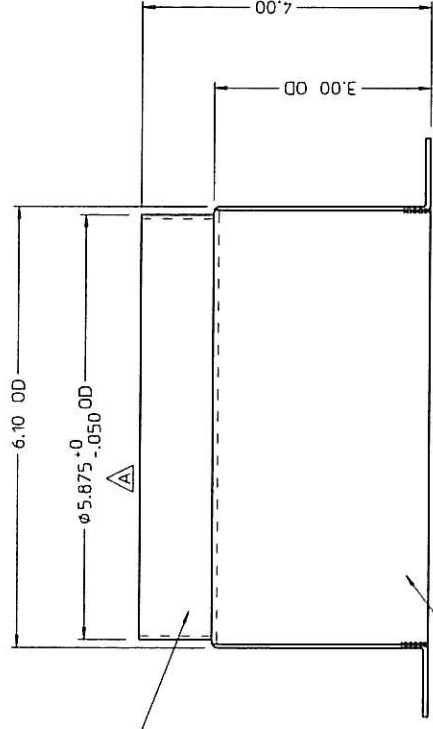

ADAPTER RING
 (P/N 303866)
 (SITS ON TOP &
 CENTERED OVER
 HOLE)

ADAPTER HOOD
 (P/N 303867)

A	ENG. REL. FCN-11841	LND	6-11-01
(-)	ENG. REL. FCN-11725	LND	03- -01
ISSUE	BY	APP	DATE
DO NOT SCALE DWG. WAS REVISIONS			
TOL. PART NAME			
UNLESS NOTED ADAPTER ASSY HOOD			
DEC. USED ON			
0	: +.030	UNIV. HOOD	
.00	: +.020	SCALE	DMN
.000	: +.005	NONE	LND
ENG	NFL	CKD	GC
ANG. ±.1°	MATERIAL	VERDI NY	PART NO. #
			303866



APPLIANCE INSTALLER

PLEASE NOTE:

(FOR OUTSIDE EXHAUST AIR VENTING OPTION ON MDL WVG-136,
WVF-886, WV-4HS, WV-4HF, WV-4HC UNITS)

THIS VENTLESS HOOD IS FACTORY SHIPPED WITH A 6" DIAMETER OUTSIDE VENT ADAPTER FOR VENTING EXHAUST AIR OUTDOORS THROUGH A WALL OR CEILING ROOF WHEN EXCESSIVE ROOM COOKING ODORS BUILD UP.

GRAINGER WALL FAN, STOCK NUMBER 4C707 PURCHASED LOCALLY, CAN ALSO BE USED TO REMOVE ROOM ODOR WHEN THIS VENT ADAPTER IS NOT USED. IT IS THE DUCT INSTALLER'S RESPONSIBILITY TO ALWAYS COMPLY WITH LOCAL CODES.

IMPROPER OUTSIDE VENTING WILL SHORTEN APPLIANCE HOOD FILTER LIFE! THE MECHANICAL CONTRACTOR INSTALLING THE 6" DIAMETER VENT DUCT SHOULD BE AWARE OF EXTERIOR PREVAILING WIND DIRECTIONS AND NOT EXPOSE THE OPEN 6" DIAMETER TO HEAD WINDS.

DO NOT USE AN EXTERIOR VENT CAP, WHICH PROVIDES OVER .10 INCH OF STATIC PRESSURE AIR FLOW RESISTANCE AT 400 C.F.M.

TO KEEP FROM REDUCING FILTER LIFE; ALWAYS LIMIT THE OVERALL 6" DIAMETER DUCT LENGTH AND NUMBER OF BENDS TO A MINIMUM. NEVER REDUCE THE DUCT DIAMETER TO LESS THAN 6"!

Quantity	Name
8	Self Drilling Screws
1	Vent Adapter
1	This Page

303865

Bill of Material for M3-303870 Effective Date: 10/12/2012

No	Level	LI	X	Part	Desc	Qty	UM	MB	ECO	ECO Date	Start	End	Rev
1	0		X	M3-303870	KIT HOOD VENT ADAPTER VCS	1.0000	EA	E					
2	1	1		2C-303522	SCREW 6X3/8 PH PAN DRLPT	8.0000	EA	B			1/16/2009		
3	1	2		2M-303865	INSTRUCTS HOOD ADAPTER VC	1.0000	EA	B			1/16/2009		
4	1	3	P	M3-303866	ADAPTER ASSY HOOD	1.0000	EA	M			1/16/2009		
5	2	1	X	M3-303867	ADAPTER HOOD	1.0000	EA	M			1/16/2009		
6	3	2		1C-E1029	#18 GA ALUMZED CQ/48x96	0.0655	SH	B	7655	2/24/2009	2/24/2009		-
7	2	2	X	M3-303868	ADAPTER RING	1.0000	EA	M			1/16/2009		
8	3	2		1C-E1029	#18 GA ALUMZED CQ/48x96	0.0039	SH	B	7655	2/24/2009	2/24/2009		-
9	1	4		2M-303869	OPT HOOD ADAPTER SHEET	1.0000	EA	B			1/16/2009		
10	1	5		2G-33727	CARTON 8X8X6 SERVICE S701	1.0000	EA	B			1/16/2009		